

3 Double Bed Apartment For Sale Harrowby Street W1H

Landward Court, Marylebone, W1H 5HB

£695,000



Property Details

Property Type	Flat	Reference	1715
---------------	------	-----------	------

Bedrooms	3 Bedrooms	Bathrooms	2 Bathrooms
Receptions	1 Reception	Status	Available

Description

Bright and Spacious 3 Double Bedroom Apartment for Sale in Landward Court W1H

Totalling approximately 870 sq ft, this 3 bedroom, 2 bathroom apartment set in a purpose built block with day porter is offered for sale with vacant possession. The apartment has large windows giving lots of light, modern kitchen, plenty of storage, spacious reception/dining room. Landward Court W1H is located on the corner of Harrowby Street and Brendon Street W1H. A ten minute walk to Baker Street, Marble Arch and Hyde Park. Nearest Underground Station is Edgware Road. Marylebone and Paddington Main Line station close by. Supermarkets, coffee shops and restaurants all within walking distance.

Key Features

- Entrance Hall
- Double Reception Room
- 3 Double Bedrooms
- Family Bathroom
- Leasehold
- Entry Phone System
- Day Porter
- Modern Purpose Built Block
- Good Condition Throughout
- £700 pa Ground Rent

Park Estates London

15 Dorset Street, London W1U 6PX

Tel: 020 7486 2828 | Email: info@parkestateslondon.co.uk

www.parkestateslondon.co.uk

The Landward Apartments

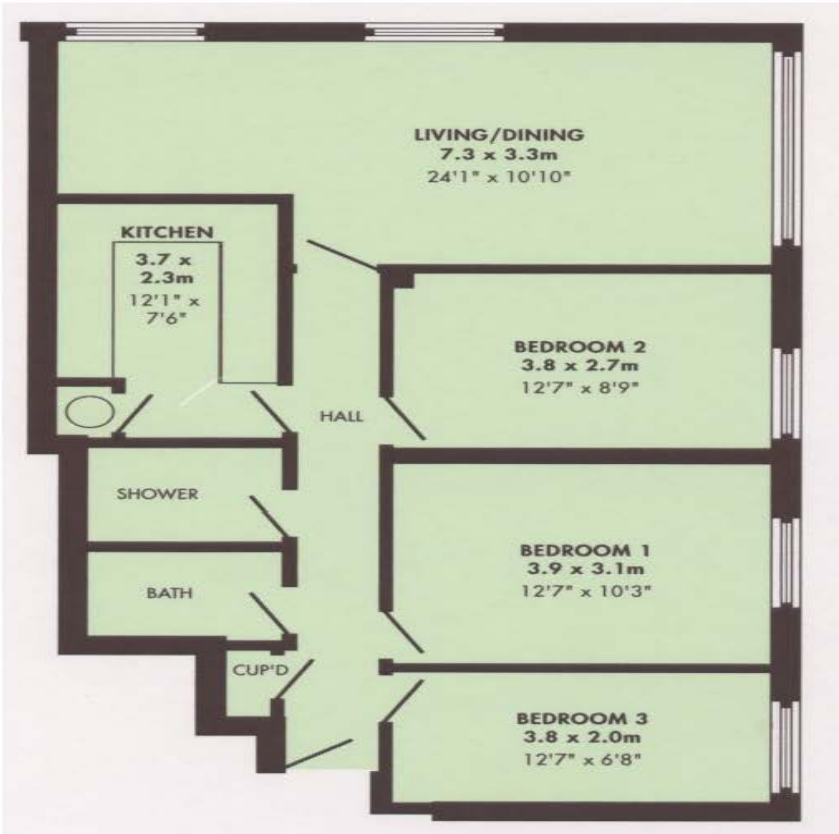

870 Square feet
81 Square Metres

These particulars are intended to give a fair description and give guidance to intending purchasers/tenants and do not constitute an offer or contract. All measurements are approximate and for guidance only. Park Estates London.